

# ELEVATION CERTIFICATE

Important: Read the instructions on pages 1-9.

13-6073  
OMB No. 1660-0008  
Expiration Date: July 31, 2015

## SECTION A - PROPERTY INFORMATION

### FOR INSURANCE COMPANY USE

A1. Building Owner's Name FLINT RIVER HABITAT FOR HUMANITY

Policy Number:

A2. Building Street Address (including Apt., Unit, Suite, and/or Bldg. No.) or P.O. Route and Box No.  
903 WILLOW OAK COURT

Company NAIC Number:

City ALBANY

State GA

ZIP Code 31701

A3. Property Description (Lot and Block Numbers, Tax Parcel Number, Legal Description, etc.)  
LOT 43 WOODLAND OAKS SUBD.

A4. Building Use (e.g., Residential, Non-Residential, Addition, Accessory, etc.) RESIDENTIAL

A5. Latitude/Longitude: Lat. N 31°32'30.13" Long. W 084°10'29.3"

Horizontal Datum: ☐ NAD 1927 ☒ NAD 1983

A6. Attach at least 2 photographs of the building if the Certificate is being used to obtain flood insurance.

A7. Building Diagram Number 1B

A8. For a building with a crawlspace or enclosure(s):

- a) Square footage of crawlspace or enclosure(s) N/A sq ft  
b) Number of permanent flood openings in the crawlspace or enclosure(s) within 1.0 foot above adjacent grade N/A  
c) Total net area of flood openings in A8.b N/A sq in  
d) Engineered flood openings? ☐ Yes ☒ No

A9. For a building with an attached garage:

- a) Square footage of attached garage N/A sq ft  
b) Number of permanent flood openings in the attached garage within 1.0 foot above adjacent grade N/A  
c) Total net area of flood openings in A9.b N/A sq in  
d) Engineered flood openings? ☐ Yes ☒ No

## SECTION B - FLOOD INSURANCE RATE MAP (FIRM) INFORMATION

B1. NFIP Community Name & Community Number  
ALBANY, CITY OF 130075

B2. County Name  
DOUGHERTY

B3. State  
GA

B4. Map/Panel Number  
13095C0116

B5. Suffix  
E

B6. FIRM Index Date  
SEPT. 25, 2009

B7. FIRM Panel Effective/Revised Date  
SEPT. 25, 2009

B8. Flood Zone(s)  
AE

B9. Base Flood Elevation(s) (Zone AO, use base flood depth)  
181.4

B10. Indicate the source of the Base Flood Elevation (BFE) data or base flood depth entered in Item B9.

☐ FIS Profile ☒ FIRM ☐ Community Determined ☐ Other/Source: \_\_\_\_\_

B11. Indicate elevation datum used for BFE in Item B9: ☐ NGVD 1929 ☒ NAVD 1988 ☐ Other/Source: \_\_\_\_\_

B12. Is the building located in a Coastal Barrier Resources System (CBRS) area or Otherwise Protected Area (OPA)? ☐ Yes ☒ No  
Designation Date: \_\_\_\_\_ ☐ CBRS ☐ OPA

## SECTION C - BUILDING ELEVATION INFORMATION (SURVEY REQUIRED)

C1. Building elevations are based on: ☐ Construction Drawings\* ☐ Building Under Construction\* ☒ Finished Construction

\*A new Elevation Certificate will be required when construction of the building is complete.

C2. Elevations - Zones A1-A30, AE, AH, A (with BFE), VE, V1-V30, V (with BFE), AR, AR/A, AR/AE, AR/A1-A30, AR/AH, AR/AO. Complete Items C2.a-h below according to the building diagram specified in Item A7. In Puerto Rico only, enter meters.

Benchmark Utilized: BT0253

Vertical Datum: 190.8 NAVD 1988

Indicate elevation datum used for the elevations in items a) through h) below. ☐ NGVD 1929 ☒ NAVD 1988 ☐ Other/Source: \_\_\_\_\_

Datum used for building elevations must be the same as that used for the BFE.

Check the measurement used.

- a) Top of bottom floor (including basement, crawlspace, or enclosure floor) 182.8 ☒ feet ☐ meters  
b) Top of the next higher floor N/A ☐ feet ☐ meters  
c) Bottom of the lowest horizontal structural member (V Zones only) N/A ☐ feet ☐ meters  
d) Attached garage (top of slab) N/A ☐ feet ☐ meters  
e) Lowest elevation of machinery or equipment servicing the building 183.0 ☒ feet ☐ meters  
(Describe type of equipment and location in Comments)  
f) Lowest adjacent (finished) grade next to building (LAG) 178.6 ☒ feet ☐ meters  
g) Highest adjacent (finished) grade next to building (HAG) 179.3 ☒ feet ☐ meters  
h) Lowest adjacent grade at lowest elevation of deck or stairs, including structural support 179.2 ☒ feet ☐ meters

## SECTION D - SURVEYOR, ENGINEER, OR ARCHITECT CERTIFICATION

This certification is to be signed and sealed by a land surveyor, engineer, or architect authorized by law to certify elevation information. I certify that the information on this Certificate represents my best efforts to interpret the data available. I understand that any false statement may be punishable by fine or imprisonment under 18 U.S. Code, Section 1001.

☒ Check here if comments are provided on back of form. Were latitude and longitude in Section A provided by a  
☐ Check here if attachments. licensed land surveyor? ☒ Yes ☐ No

Certifier's Name CARY F. REED

License Number GA RLS 2896

Title SURVEY DIRECTOR

Company Name EMC ENGINEERING SERVICES, INC.

Address 1344 US HWY SOUTH SUITE A

City LEESBURG

State GA

ZIP Code 31763

Signature Cary F. Reed

Date 9/25/2014

Telephone 229-435-6133

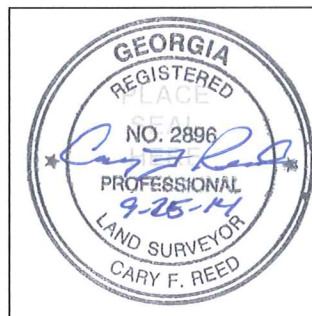

**IMPORTANT: In these spaces, copy the corresponding information from Section A.****FOR INSURANCE COMPANY USE**Building Street Address (including Apt., Unit, Suite, and/or Bldg. No.) or P.O. Route and Box No.  
903 WILLOW OAK COURT

Policy Number:

City ALBANY

State GA ZIP Code 31701

Company NAIC Number:

**SECTION D – SURVEYOR, ENGINEER, OR ARCHITECT CERTIFICATION (CONTINUED)**

Copy both sides of this Elevation Certificate for (1) community official, (2) insurance agent/company, and (3) building owner.

Comments Section C Item C2e elevation shown to top of AC pad on left side of house.

Signature



Date 9/25/2014

**SECTION E – BUILDING ELEVATION INFORMATION (SURVEY NOT REQUIRED) FOR ZONE AO AND ZONE A (WITHOUT BFE)**

For Zones AO and A (without BFE), complete Items E1–E5. If the Certificate is intended to support a LOMA or LOMR-F request, complete Sections A, B, and C. For Items E1–E4, use natural grade, if available. Check the measurement used. In Puerto Rico only, enter meters.

E1. Provide elevation information for the following and check the appropriate boxes to show whether the elevation is above or below the highest adjacent grade (HAG) and the lowest adjacent grade (LAG).

a) Top of bottom floor (including basement, crawlspace, or enclosure) is \_\_\_\_\_ ☐ feet ☐ meters ☐ above or ☐ below the HAG.b) Top of bottom floor (including basement, crawlspace, or enclosure) is \_\_\_\_\_ ☐ feet ☐ meters ☐ above or ☐ below the LAG.E2. For Building Diagrams 6–9 with permanent flood openings provided in Section A Items 8 and/or 9 (see pages 8–9 of Instructions), the next higher floor (elevation C2.b in the diagrams) of the building is \_\_\_\_\_ ☐ feet ☐ meters ☐ above or ☐ below the HAG.E3. Attached garage (top of slab) is \_\_\_\_\_ ☐ feet ☐ meters ☐ above or ☐ below the HAG.E4. Top of platform of machinery and/or equipment servicing the building is \_\_\_\_\_ ☐ feet ☐ meters ☐ above or ☐ below the HAG.E5. Zone AO only: If no flood depth number is available, is the top of the bottom floor elevated in accordance with the community's floodplain management ordinance? ☐ Yes ☐ No ☐ Unknown. The local official must certify this information in Section G.**SECTION F – PROPERTY OWNER (OR OWNER'S REPRESENTATIVE) CERTIFICATION**

The property owner or owner's authorized representative who completes Sections A, B, and E for Zone A (without a FEMA-issued or community-issued BFE) or Zone AO must sign here. The statements in Sections A, B, and E are correct to the best of my knowledge.

Property Owner's or Owner's Authorized Representative's Name

Address City State ZIP Code

Signature Date Telephone

Comments

☐ Check here if attachments.**SECTION G – COMMUNITY INFORMATION (OPTIONAL)**

The local official who is authorized by law or ordinance to administer the community's floodplain management ordinance can complete Sections A, B, C (or E), and G of this Elevation Certificate. Complete the applicable item(s) and sign below. Check the measurement used in Items G8–G10. In Puerto Rico only, enter meters.

G1. ☐ The information in Section C was taken from other documentation that has been signed and sealed by a licensed surveyor, engineer, or architect who is authorized by law to certify elevation information. (Indicate the source and date of the elevation data in the Comments area below.)G2. ☐ A community official completed Section E for a building located in Zone A (without a FEMA-issued or community-issued BFE) or Zone AO.G3. ☐ The following information (Items G4–G10) is provided for community floodplain management purposes.

G4. Permit Number	G5. Date Permit Issued	G6. Date Certificate Of Compliance/Occupancy Issued
-------------------	------------------------	---

G7. This permit has been issued for: ☐ New Construction ☐ Substantial ImprovementG8. Elevation of as-built lowest floor (including basement) of the building: \_\_\_\_\_ ☐ feet ☐ meters Datum \_\_\_\_\_G9. BFE or (in Zone AO) depth of flooding at the building site: \_\_\_\_\_ ☐ feet ☐ meters Datum \_\_\_\_\_G10. Community's design flood elevation: \_\_\_\_\_ ☐ feet ☐ meters Datum \_\_\_\_\_

Local Official's Name Title

Community Name Telephone

Signature Date

Comments

☐ Check here if attachments.

# Building Photographs

See Instructions for Item A6.

**IMPORTANT:** In these spaces, copy the corresponding information from Section A.Building Street Address (including Apt., Unit, Suite, and/or Bldg. No.) or P.O. Route and Box No.  
903 WILLOW OAK COURT

City ALBANY

State GA

ZIP Code 31701

FOR INSURANCE COMPANY USE

Policy Number:

Company NAIC Number:

If using the Elevation Certificate to obtain NFIP flood insurance, affix at least 2 building photographs below according to the instructions for Item A6. Identify all photographs with date taken; "Front View" and "Rear View"; and, if required, "Right Side View" and "Left Side View." When applicable, photographs must show the foundation with representative examples of the flood openings or vents, as indicated in Section A8. If submitting more photographs than will fit on this page, use the Continuation Page.

FRONT CENTER



REAR CENTER



Building Photographs

Continuation Page

IMPORTANT: In these spaces, copy the corresponding information from Section A.

Building Street Address (including Apt., Unit, Suite, and/or Bldg. No.) or P.O. Route and Box No.  
903 WILLOW OAK COURT

City Albany

State GA

ZIP Code 31701

FOR INSURANCE COMPANY USE

Policy Number:

Company NAIC Number:

If submitting more photographs than will fit on the preceding page, affix the additional photographs below. Identify all photographs with: date taken; "Front View" and "Rear View"; and, if required, "Right Side View" and "Left Side View." When applicable, photographs must show the foundation with representative examples of the flood openings or vents, as indicated in Section A8.

RIGHT SIDE



LEFT SIDE

