

# ELEVATION CERTIFICATE

OMB No. 1660-0008  
Expires March 31, 2012

Important: Read the instructions on pages 1-9.

## SECTION A - PROPERTY INFORMATION

A1. Building Owner's Name City of Albany		For Insurance Company Use:
A2. Building Street Address (including Apt., Unit, Suite, and/or Bldg. No.) or P.O. Route and Box No. 1401 South Martin Luther King Jr. Street		Policy Number
City Albany State GA ZIP Code 31701		Company NAIC Number
A3. Property Description (Lot and Block Numbers, Tax Parcel Number, Legal Description, etc.) Dougherty County Tax Parcel No. 00001/00022/001		
A4. Building Use (e.g., Residential, Non-Residential, Addition, Accessory, etc.) <u>Apartment</u>		
A5. Latitude/Longitude: Lat. <u>31d33'37"</u> Long. <u>84d09'19"</u>		Horizontal Datum: <input type="checkbox"/> NAD 1927 <input checked="" type="checkbox"/> NAD 1983
A6. Attach at least 2 photographs of the building if the Certificate is being used to obtain flood insurance.		
A7. Building Diagram Number <u>2</u>		
A8. For a building with a crawlspace or enclosure(s):		A9. For a building with an attached garage:
a) Square footage of crawlspace or enclosure(s) <u>2780</u> sq ft		a) Square footage of attached garage _____ sq ft
b) No. of permanent flood openings in the crawlspace or enclosure(s) within 1.0 foot above adjacent grade <u>21</u>		b) No. of permanent flood openings in the attached garage within 1.0 foot above adjacent grade _____
c) Total net area of flood openings in A8.b <u>2450</u> sq in		c) Total net area of flood openings in A9.b _____ sq in
d) Engineered flood openings? <input type="checkbox"/> Yes <input checked="" type="checkbox"/> No		d) Engineered flood openings? <input type="checkbox"/> Yes <input type="checkbox"/> No

## SECTION B - FLOOD INSURANCE RATE MAP (FIRM) INFORMATION

B1. NFIP Community Name & Community Number City of Albany 130075		B2. County Name Dougherty		B3. State Georgia	
B4. Map/Panel Number 13095C0120	B5. Suffix D	B6. FIRM Index Date 10-5-2001	B7. FIRM Panel Effective/Revised Date 10-502001	B8. Flood Zone(s) AE	B9. Base Flood Elevation(s) (Zone AO, use base flood depth) 184.5
B10. Indicate the source of the Base Flood Elevation (BFE) data or base flood depth entered in Item B9. <input type="checkbox"/> FIS Profile <input checked="" type="checkbox"/> FIRM <input type="checkbox"/> Community Determined <input type="checkbox"/> Other (Describe) _____					
B11. Indicate elevation datum used for BFE in Item B9: <input checked="" type="checkbox"/> NGVD 1929 <input type="checkbox"/> NAVD 1988 <input type="checkbox"/> Other (Describe) _____					
B12. Is the building located in a Coastal Barrier Resources System (CBRS) area or Otherwise Protected Area (OPA)? <input type="checkbox"/> Yes <input checked="" type="checkbox"/> No Designation Date _____ <input type="checkbox"/> CBRS <input type="checkbox"/> OPA					

## SECTION C - BUILDING ELEVATION INFORMATION (SURVEY REQUIRED)

C1. Building elevations are based on: ☐ Construction Drawings\* ☐ Building Under Construction\* ☒ Finished Construction  
\*A new Elevation Certificate will be required when construction of the building is complete.

C2. Elevations - Zones A1-A30, AE, AH, A (with BFE), VE, V1-V30, V (with BFE), AR, AR/A, AR/AE, AR/A1-A30, AR/AH, AR/AO. Complete Items C2.a-h below according to the building diagram specified in Item A7. Use the same datum as the BFE.  
Benchmark Utilized PIDBT2319 Vertical Datum 1929  
Conversion/Comments \_\_\_\_\_

Check the measurement used.

a) Top of bottom floor (including basement, crawlspace, or enclosure floor)	<u>183.25</u>	<input checked="" type="checkbox"/> feet <input type="checkbox"/> meters (Puerto Rico only)
b) Top of the next higher floor	<u>186.10</u>	<input checked="" type="checkbox"/> feet <input type="checkbox"/> meters (Puerto Rico only)
c) Bottom of the lowest horizontal structural member (V Zones only)	_____	<input type="checkbox"/> feet <input type="checkbox"/> meters (Puerto Rico only)
d) Attached garage (top of slab)	_____	<input type="checkbox"/> feet <input type="checkbox"/> meters (Puerto Rico only)
e) Lowest elevation of machinery or equipment servicing the building (Describe type of equipment and location in Comments)	<u>186.11</u>	<input checked="" type="checkbox"/> feet <input type="checkbox"/> meters (Puerto Rico only)
f) Lowest adjacent (finished) grade next to building (LAG)	<u>182.56</u>	<input checked="" type="checkbox"/> feet <input type="checkbox"/> meters (Puerto Rico only)
g) Highest adjacent (finished) grade next to building (HAG)	<u>183.40</u>	<input checked="" type="checkbox"/> feet <input type="checkbox"/> meters (Puerto Rico only)
h) Lowest adjacent grade at lowest elevation of deck or stairs, including structural support	<u>182.68</u>	<input checked="" type="checkbox"/> feet <input type="checkbox"/> meters (Puerto Rico only)

## SECTION D - SURVEYOR, ENGINEER, OR ARCHITECT CERTIFICATION

This certification is to be signed and sealed by a land surveyor, engineer, or architect authorized by law to certify elevation information. I certify that the information on this Certificate represents my best efforts to interpret the data available. I understand that any false statement may be punishable by fine or imprisonment under 18 U.S. Code, Section 1001.

☒ Check here if comments are provided on back of form. Were latitude and longitude in Section A provided by a licensed land surveyor? ☒ Yes ☐ No

Certifier's Name Charles R. Hutchinson License Number Georgia 2639  
Title Civil Engineering Superintendent Company Name City of Albany, Engineering Department  
Address P.O. Box 447 240 Pine Avenue City Albany State GA ZIP Code 31701  
Signature Charles R. Hutchinson Date 06-24-09 Telephone 229 883 6955

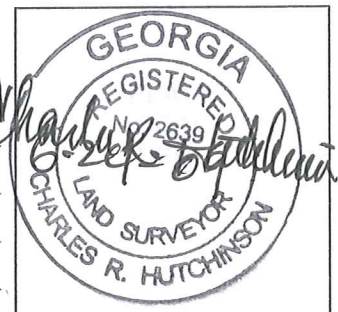



**IMPORTANT: In these spaces, copy the corresponding information from Section A.**

Building Street Address (including Apt., Unit, Suite, and/or Bldg. No.) or P.O. Route and Box No.

1401 Martin Luther King Jr. Street

City AlbanyState GA ZIP Code 31701

For Insurance Company Use:

Policy Number

Company NAIC Number

**SECTION D - SURVEYOR, ENGINEER, OR ARCHITECT CERTIFICATION (CONTINUED)**

Copy both sides of this Elevation Certificate for (1) community official, (2) insurance agent/company, and (3) building owner.

Comments C2e AC unit.



Signature Charles R. Hutchinson

Date 06-24-09

☐ Check here if attachments**SECTION E - BUILDING ELEVATION INFORMATION (SURVEY NOT REQUIRED) FOR ZONE AO AND ZONE A (WITHOUT BFE)**

For Zones AO and A (without BFE), complete Items E1-E5. If the Certificate is intended to support a LOMA or LOMR-F request, complete Sections A, B, and C. For Items E1-E4, use natural grade, if available. Check the measurement used. In Puerto Rico only, enter meters.

E1. Provide elevation information for the following and check the appropriate boxes to show whether the elevation is above or below the highest adjacent grade (HAG) and the lowest adjacent grade (LAG).

a) Top of bottom floor (including basement, crawlspace, or enclosure) is \_\_\_\_\_ ☐ feet ☐ meters ☐ above or ☐ below the HAG.b) Top of bottom floor (including basement, crawlspace, or enclosure) is \_\_\_\_\_ ☐ feet ☐ meters ☐ above or ☐ below the LAG.E2. For Building Diagrams 6-9 with permanent flood openings provided in Section A Items 8 and/or 9 (see pages 8-9 of Instructions), the next higher floor (elevation C2.b in the diagrams) of the building is \_\_\_\_\_ ☐ feet ☐ meters ☐ above or ☐ below the HAG.E3. Attached garage (top of slab) is \_\_\_\_\_ ☐ feet ☐ meters ☐ above or ☐ below the HAG.E4. Top of platform of machinery and/or equipment servicing the building is \_\_\_\_\_ ☐ feet ☐ meters ☐ above or ☐ below the HAG.E5. Zone AO only: If no flood depth number is available, is the top of the bottom floor elevated in accordance with the community's floodplain management ordinance? ☐ Yes ☐ No ☐ Unknown. The local official must certify this information in Section G.**SECTION F - PROPERTY OWNER (OR OWNER'S REPRESENTATIVE) CERTIFICATION**The property owner or owner's authorized representative who completes Sections A, B, and E for Zone A (without a FEMA-issued or community-issued BFE) or Zone AO must sign here. *The statements in Sections A, B, and E are correct to the best of my knowledge.*

Property Owner's or Owner's Authorized Representative's Name

Address City State ZIP Code

Signature Date Telephone

Comments

☐ Check here if attachments**SECTION G - COMMUNITY INFORMATION (OPTIONAL)**

The local official who is authorized by law or ordinance to administer the community's floodplain management ordinance can complete Sections A, B, C (or E), and G of this Elevation Certificate. Complete the applicable item(s) and sign below. Check the measurement used in Items G8 and G9.

G1. ☐ The information in Section C was taken from other documentation that has been signed and sealed by a licensed surveyor, engineer, or architect who is authorized by law to certify elevation information. (Indicate the source and date of the elevation data in the Comments area below.)G2. ☐ A community official completed Section E for a building located in Zone A (without a FEMA-issued or community-issued BFE) or Zone AO.G3. ☐ The following information (Items G4-G9) is provided for community floodplain management purposes.

G4. Permit Number

G5. Date Permit Issued

G6. Date Certificate Of Compliance/Occupancy Issued

G7. This permit has been issued for: ☐ New Construction ☐ Substantial ImprovementG8. Elevation of as-built lowest floor (including basement) of the building: \_\_\_\_\_ ☐ feet ☐ meters (PR) Datum \_\_\_\_\_G9. BFE or (in Zone AO) depth of flooding at the building site: \_\_\_\_\_ ☐ feet ☐ meters (PR) Datum \_\_\_\_\_G10. Community's design flood elevation \_\_\_\_\_ ☐ feet ☐ meters (PR) Datum \_\_\_\_\_

Local Official's Name

Title

Community Name

Telephone

Signature

Date

Comments

☐ Check here if attachments



# Building Photographs

See Instructions for Item A6.

<b>Building Street Address (including Apt., Unit, Suite, and/or Bldg. No.) or P.O. Route and Box No.</b> 1401 South Martin Luther King Jr. Street	<b>For Insurance Company Use:</b> Policy Number
<b>City</b> aLBANY <b>State</b> GA <b>ZIP Code</b> 31701	<b>Company NAIC Number</b>
<p>If using the Elevation Certificate to obtain NFIP flood insurance, affix at least two building photographs below according to the instructions for Item A6. Identify all photographs with: date taken; "Front View" and "Rear View"; and, if required, "Right Side View" and "Left Side View." If submitting more photographs than will fit on this page, use the Continuation Page on the reverse.</p>	



**FRONT VIEW**



**REAR VIEW**



# Building Photographs

Continuation Page

<b>Building Street Address (including Apt., Unit, Suite, and/or Bldg. No.) or P.O. Route and Box No.</b> 1401 South Martin Luther King Jr. Street	<b>For Insurance Company Use:</b> Policy Number
<b>City Albany State GA ZIP Code 31701</b>	Company NAIC Number
If submitting more photographs than will fit on the preceding page, affix the additional photographs below. Identify all photographs with: date taken; "Front View" and "Rear View"; and, if required, "Right Side View" and "Left Side View."	



**LEFT SIDE**



**RIGHT SIDE**